



Farm & Garden Equipment

DelMorino SRL

Del Morino srl, v. Caroni di Sotto 19,
I-52033 Caprese Michelangelo AR Italy
Ph: +39-575-791059 Fax: +39-575-791210
E.mail: export@del-morino.it
<http://www.del-morino.it>

USE AND MAINTENANCE MANUAL

ROTARY TILLER & STONE BURIERS FLASH

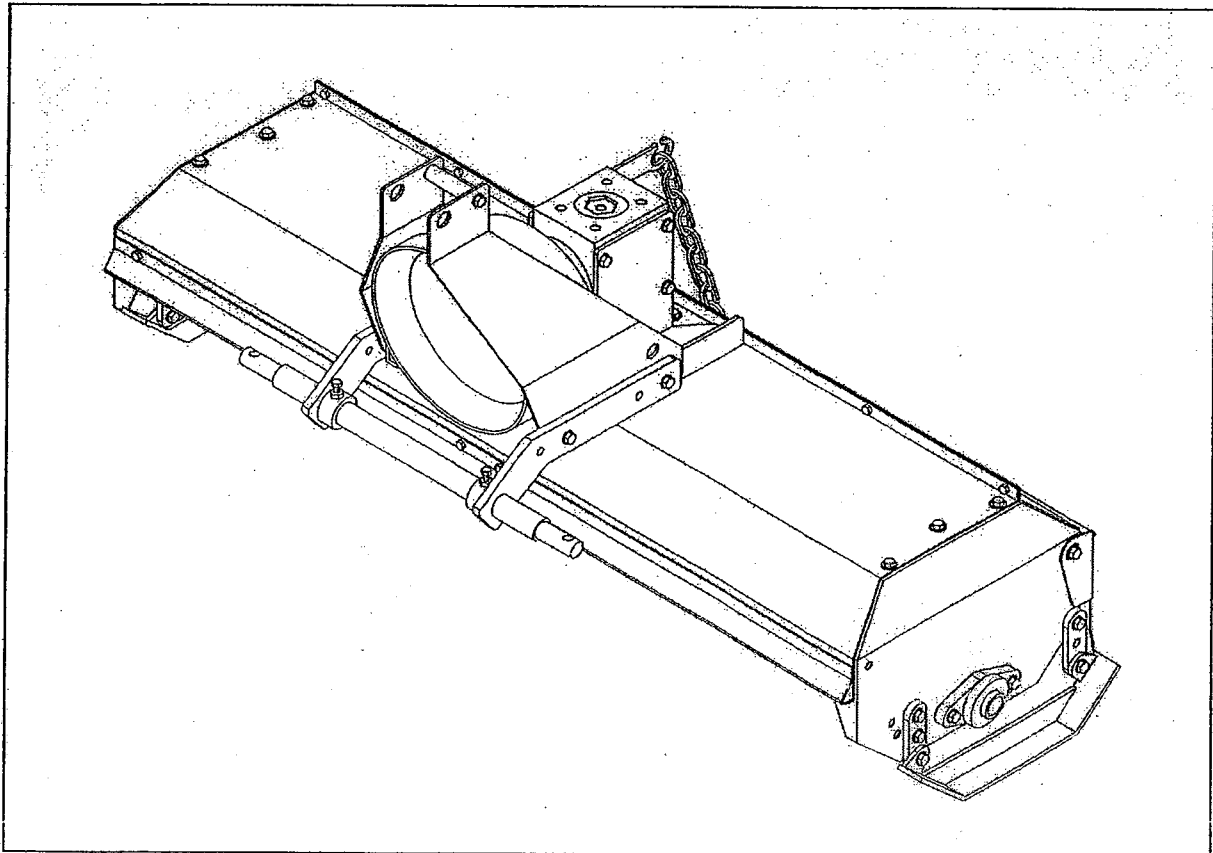

SPARE PARTS AND OPTIONS

SHEETS

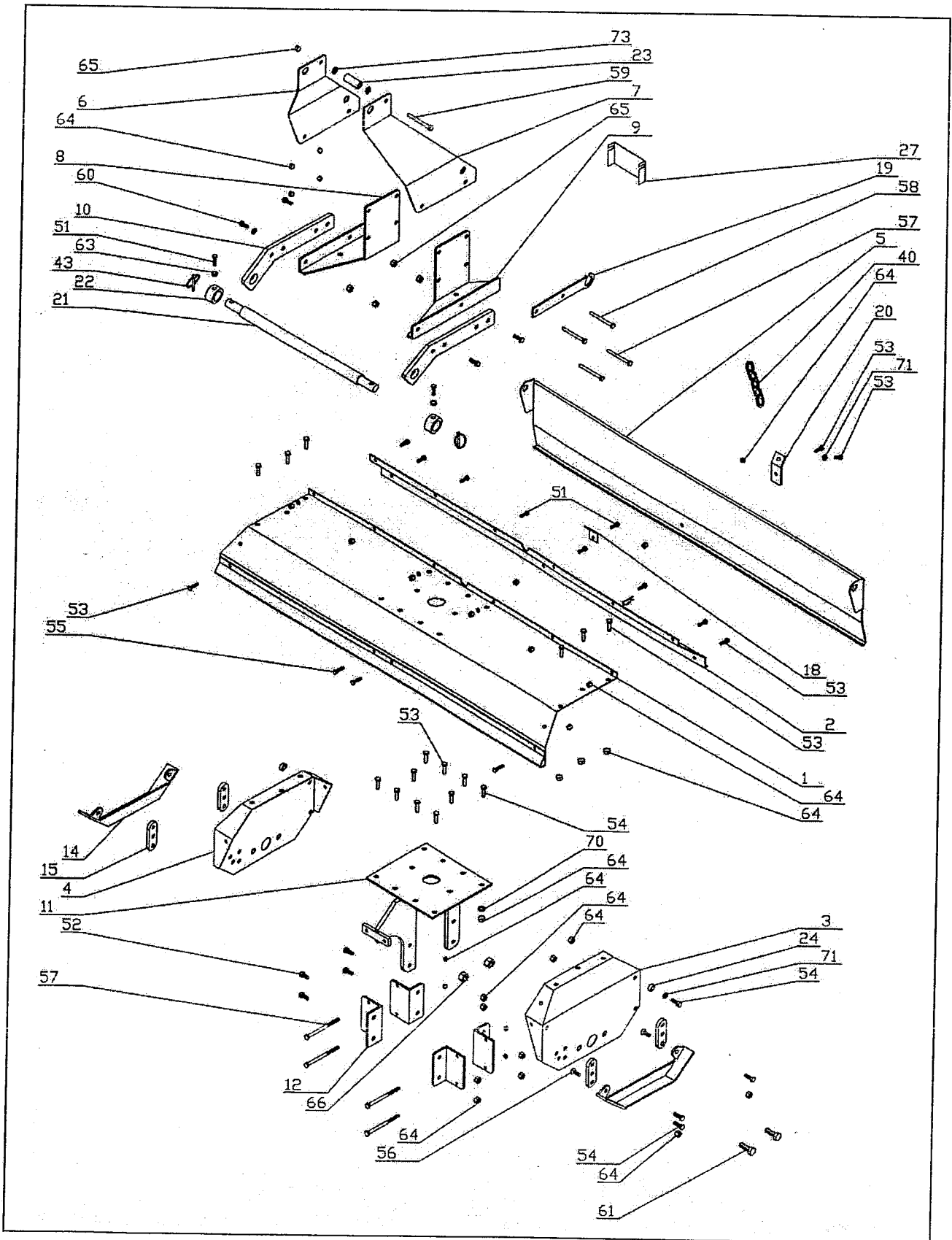

MECHANISMS

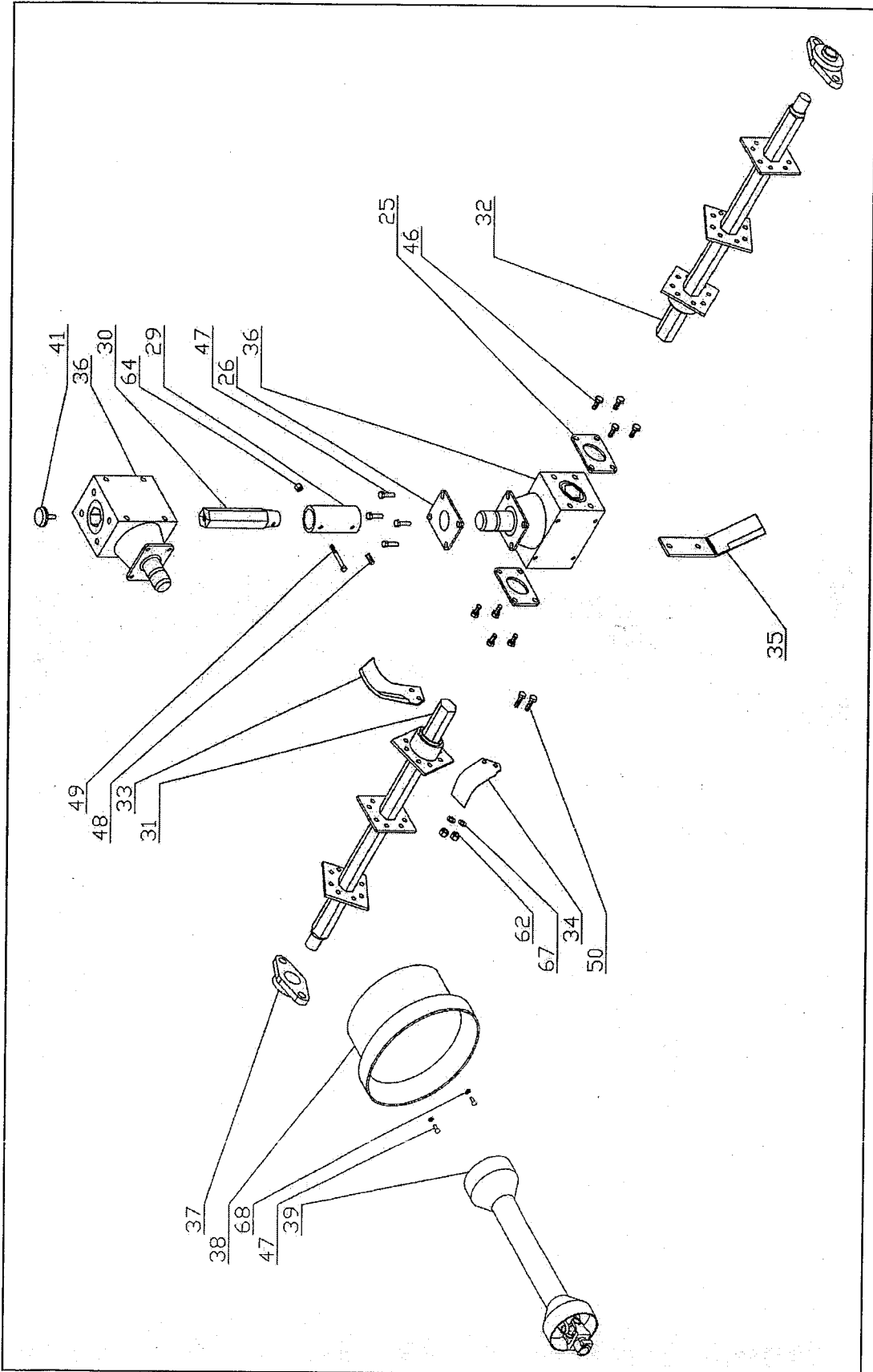

SPARE PARTS LIST

| Position | Code | Description | Quantity | | |
|----------|-----------|-----------------------------|----------|-----|-----|
| | | | 85 | 105 | 125 |
| 1 | SOL051AVD | Front deck 85 | 1 | | |
| 1 | SOL051BVD | Front deck 105 | | 1 | |
| 1 | SOL051CVD | Front deck 125 | | | 1 |
| 2 | SOL158AVD | Rear deck 85 | 1 | | |
| 2 | SOL158BVD | Rear deck 105 | | 1 | |
| 2 | SOL158CVD | Rear deck 125 | | | 1 |
| 3 | SOL052VD | Left side | 1 | 1 | 1 |
| 4 | SOL053VD | Right side | 1 | 1 | 1 |
| 5 | SOL161AVD | Tail board 85 | 1 | | |
| 5 | SOL161BVD | Tail board 105 | | 1 | |
| 5 | SOL161CVD | Tail board 125 | | | 1 |
| 6 | SOL152VD | III° point right side | 1 | 1 | 1 |
| 7 | SOL151VD | III° point left side | 1 | 1 | 1 |
| 8 | SOL157VD | Right gear box holder | 1 | 1 | 1 |
| 9 | SOL156VD | Left gear box holder | 1 | 1 | 1 |
| 10 | SOL181VD | Bracket | 2 | 2 | 2 |
| 11 | SOL054VD | Lower gear box holder | 1 | 1 | 1 |
| 12 | SOL159VD | Lower gear box bracket | 4 | 4 | 4 |
| 13 | | | | | |
| 14 | SOL055VD | Slide | 2 | 2 | 2 |
| 15 | SOL056VD | Slide adjuster | 4 | 4 | 4 |
| 16 | | | | | |
| 17 | | | | | |
| 18 | SOL184VD | Tail boar protection | 1 | 1 | 1 |
| 19 | SOL183VD | Chain holder | 1 | 1 | 1 |
| 20 | HOL203VD | Chain holder – tail board | 1 | 1 | 1 |
| 21 | SOL175D | Shaft | 1 | 1 | 1 |
| 22 | SOL059VD | Shaft locker | 2 | 2 | 2 |
| 23 | SOL154VD | III° point bush | 1 | 1 | 1 |
| 24 | SOL169VD | Tail board bush | 2 | 2 | 2 |
| 25 | SOL060VD | Lower gear box side flange | 2 | 2 | 2 |
| 26 | SOL167VD | Lower gear box upper flange | 1 | 1 | 1 |
| 27 | SOL189VD | Cover | 1 | 1 | 1 |
| 28 | | | | | |
| 29 | SOL062VD | Transmission bush | 1 | 1 | 1 |
| 30 | SOL165D | Transmission shaft | 1 | 1 | 1 |
| 31 | SOL063AVD | Right rotor 85 | 1 | | |
| 31 | SOL063BVD | Right rotor 105 | | 1 | |
| 31 | SOL063CVD | Right rotor 125 | | | 1 |
| 32 | SOL064AVD | Left rotor 85 | 1 | | |
| 32 | SOL064BVD | Left rotor 105 | | 1 | |
| 32 | SOL064CVD | Left rotor 125 | | | 1 |
| 33 | HOL154D | Right blade | 8 | 10 | 12 |
| 34 | HOL215D | Left blade | 8 | 10 | 12 |
| 35 | SOL200D | Middle blade | 1 | 1 | 1 |
| 36 | 42000003 | Gear box | 2 | 2 | 2 |
| 37 | 42400006 | Pillow block UCFL 205 | 2 | 2 | 2 |
| 38 | 41900008 | Plastic protection | 1 | 1 | 1 |
| 39 | 42600009 | PTO shaft II° L=700 | 1 | 1 | 1 |
| 40 | 40900001 | Chain | 1 | 1 | 1 |
| 41 | 42200005 | Handle M10x15 | 1 | 1 | 1 |
| 42 | | | | | |
| 43 | 41300001 | Safety pin Ø10 | 2 | 2 | 2 |
| 44 | | | | | |

| Position | Code | Description | Quantity | | |
|----------|----------|--------------------------------|----------|-----|-----|
| | | | 85 | 105 | 125 |
| 45 | | | | | |
| 46 | 40100139 | Screw M8x25 UNI 5933 | 8 | 8 | 8 |
| 47 | 40100077 | Screw M8x20 UNI 5739 | 6 | 6 | 6 |
| 48 | 43200002 | Set screw M10x15 UNI 5927 | 1 | 1 | 1 |
| 49 | 40100198 | Screw M10x75 UNI 5737 | 1 | 1 | 1 |
| 50 | 40100010 | Screw M12x35 UNI 5738 | 32 | 40 | 48 |
| 51 | 40100030 | Screw M10x20 UNI 5739 | 9 | 9 | 9 |
| 52 | 40100197 | Screw M10x45 UNI 5739 | 4 | 4 | 4 |
| 53 | 40100043 | Screw M10x25 UNI 5739 | 21 | 21 | 21 |
| 54 | 40100012 | Screw M10x30 UNI 5739 | 14 | 14 | 14 |
| 55 | 40100054 | Screw M10x35 UNI 5739 | 2 | 2 | 2 |
| 56 | 40100149 | Screw M10x30 UNI 5933 | 4 | 4 | 4 |
| 57 | 40100024 | Screw M10x130 UNI 5737 | 6 | 6 | 6 |
| 58 | 40100108 | Screw M10x140 UNI 5737 | 2 | 2 | 2 |
| 59 | 40100022 | Screw M12x90 UNI 5737 | 1 | 1 | 1 |
| 60 | 40100023 | Screw M12x40 UNI 5739 | 4 | 4 | 4 |
| 61 | 40100034 | Screw M16x40 UNI 5739 | 4 | 4 | 4 |
| 62 | 40200007 | Nut MB12x1,25 UNI 5587 | 32 | 40 | 48 |
| 63 | 40200005 | Nut M10 UNI 5588 | 2 | 2 | 2 |
| 64 | 40200003 | Nut M10 DIN 980 | 61 | 61 | 61 |
| 65 | 40200006 | Nut M12 DIN 980 | 5 | 5 | 5 |
| 66 | 40200008 | Nut M16 DIN 980 | 4 | 4 | 4 |
| 67 | 40300005 | Washer Ø12 UNI 9195 – DIN 127B | 32 | 40 | 48 |
| 68 | 40300031 | Washer Ø8x24 | 2 | 2 | 2 |
| 69 | | | | | |
| 70 | | | | | |
| 71 | 40300013 | Washer Ø10x30 | 3 | 3 | 3 |
| 72 | | | | | |
| 73 | 40300045 | Washer Ø12x36 | 2 | 2 | 2 |
| | | | | | |
| | | | | | |
| | | | | | |

GENERAL INDEX

| | |
|---|----|
| PREFACE | 2 |
| DESCRIPTION | 3 |
| FUNCTION OF USE..... | 3 |
| PERFORMANCES | 3 |
| PERFORMANCES LIMITS..... | 3 |
| STANDARD EQUIPMENT | 3 |
| VARIANTS & OPTIONS..... | 3 |
| TECHNICAL SPECIFICATIONS | 4 |
| SAFETY INFORMATIONS | 5 |
| GENERAL REGULATIONS..... | 5 |
| SAFETY RESTRICTIONS..... | 5 |
| SAFETY SIGNS ON THE MACHINES | 6 |
| INSTRUCTION FOR USE | 7 |
| BEFORE BEGINNING WORK | 7 |
| TO BEGINNING WORK..... | 8 |
| AT THE END OF WORK | 8 |
| MAINTENANCE INSTRUCTIONS | 9 |
| DIAGRAM "A" SCHEDULED MAINTENANCE..... | 9 |
| 1. GREASING | 10 |
| 2. OIL CHECK - OIL REPLACEMENT IN GEAR BOXES..... | 10 |
| 3. HOES SUBSTITUTION..... | 11 |
| 4. SHEAR BOLT REPLACEMENT..... | 12 |
| 5. SET UP TILLER OR STONE BURIERS..... | 13 |
| PROBLEMS SOLVING | 14 |
| TRANSPORT | 15 |
| STORAGE | 15 |
| INFORMATION ON DEMOLITION | 15 |
| WARRANTY | 15 |
| WORK AND MAINTENANCE SHEET | 16 |
| SHEETS..... | 18 |
| MECHANISMS | 19 |
| SPARE PARTS LIST | 20 |